



DEWMARK
HYDRO

WR 73/80



Joint width
80 mm



Recess
mounted



Max load
300 kN



Movements in
6 directions



Protection
rating IP 68



Indoor/
outdoor

FLOOR COVERING

TILE

POLYMER

CONCRETE

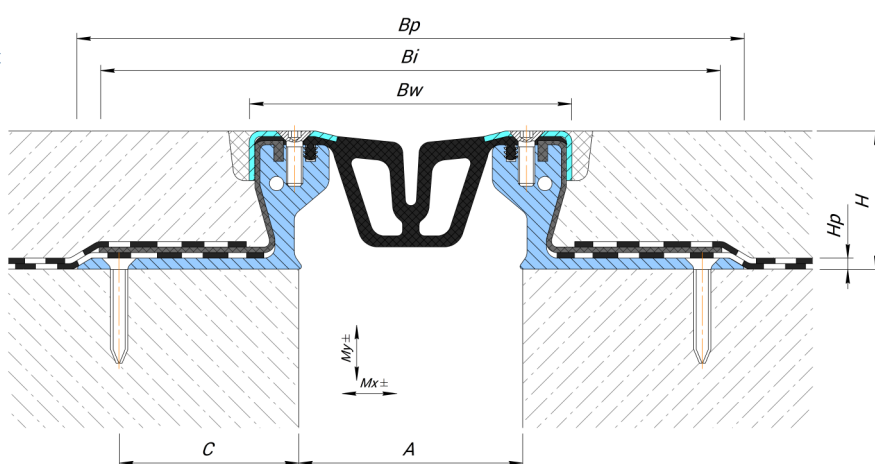

Technical data

MATERIAL

Profile: aluminium EN AW 6060T6

Plates: AISI 430 (AISI 304 or 316 to order)

Insert (shirt): PVC-P (oil and petrol resistant)

LENGTH

Profile: 2.5 meters

Plates: 2.5 meters

Insert: 25 meters

Shirt: 50 meters

STANDARD COLOR OF INSERT (RAL)

9005

Profile	A (mm)	H (mm)	Bw (mm)	Bp (mm)	Bi ¹ (mm)	C (mm)	Hp (mm)	Mx (mm)	My (mm)	Load bearing capacity, kN			
WR 73/80/25	80	25	118	240	O/R ¹	65	4	80 (+40/-40)	20 (+10/-10)	50 ²	300 ²	70 ²	—
WR 73/80/50	80	50	118	240	O/R ¹	65	4	80 (+40/-40)	20 (+10/-10)	50	300	70	
WR 73/80/75	80	75	118	240	O/R ¹	65	4	80 (+40/-40)	20 (+10/-10)	50	300	70	
WR 73/80/100	80	100	118	240	O/R ¹	65	4	80 (+40/-40)	20 (+10/-10)	50	300	70	

¹ Bi - shirt width. Depends on the type of shirt (S, M or L and the mounting height of the profile). Ask for additional information.

² Not for permanent use (requires coordination) - the risk of breaking off the topcoat.

Types of shirt



S



M



L

Shirt S - width 20 mm

Shirt M - width 160 mm

Shirt L - width 380 mm

Example : WR 73/80/50/M

Corner Versions

All profiles have angular versions in which the regular insert is replaced with an angular one. This profile has an E index.

Example: WR-E 73/80/50/S

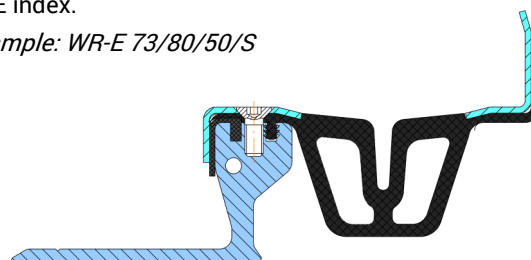



DEWMARK
HYDRO

WR 73/80

Profile versions

Profiles can be equipped with protective plates to protect the insert from mechanical damage.

This type of profile has an index "F".

Example WR 73/80/50/S F.

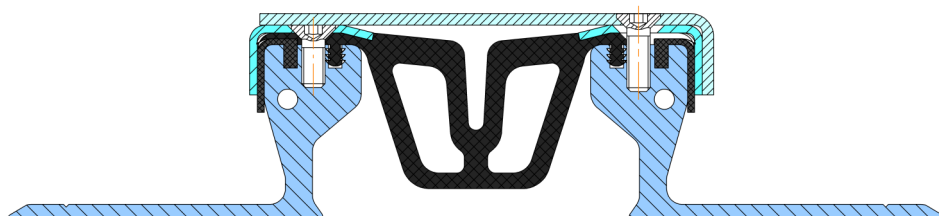

At low loads, side mounting is possible.



On request

On request, the profile can be completed with special linings that form the transition zone between the profile and the finishing coating.

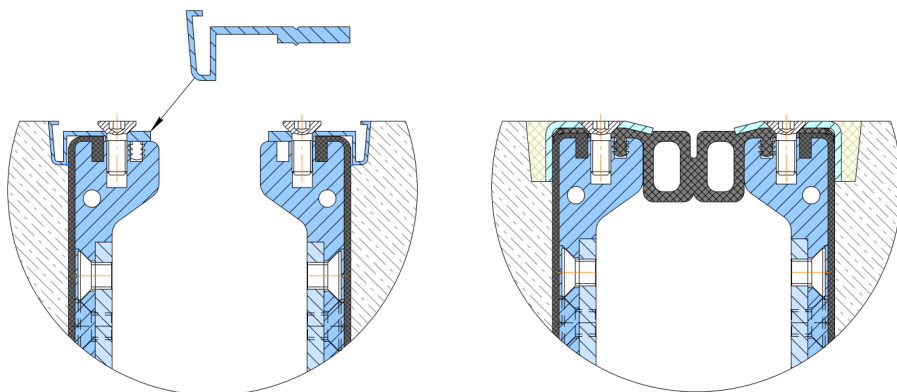

NOTE!

- ! The specified IP rating is applicable if the waterproofing of the floor is matched with profile aprons.
- ! If there is a vertical movement using the lining "F" are not allowed.
- ! By agreement, it is possible to use asphalt in the finish coating.