



DEWMARK
HYDRO

WR 79/120



Joint width
120 mm



Recess
mounted



Max load
300 kN



Movements in
6 directions



Protection
rating IP 68



Indoor/
outdoor



FLOOR COVERING → TILE → POLYMER → CONCRETE

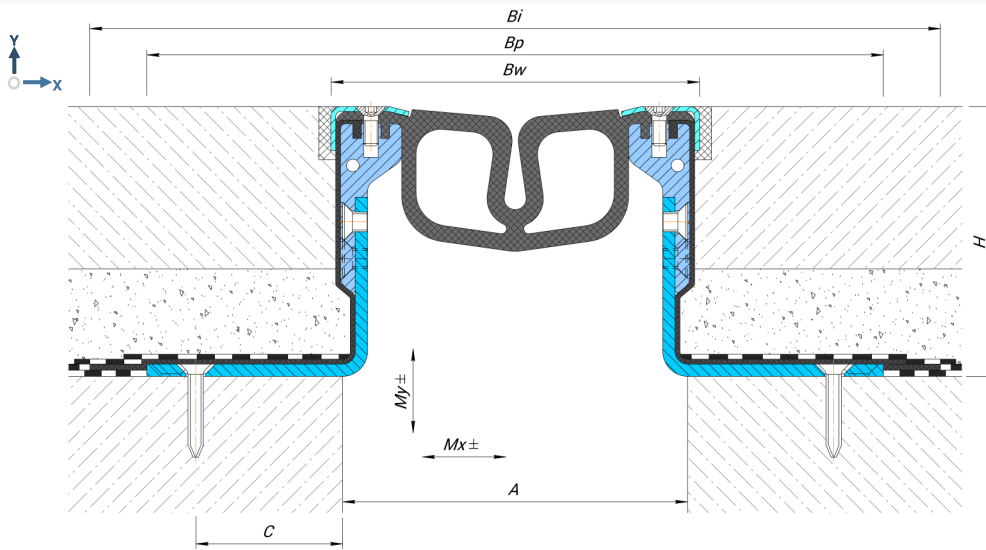

Technical data

MATERIAL

Profile: aluminium EN AW 6060T6
Plates: AISI 430 (AISI 304 or 316 to order)
Insert (shirt): PVC-P (oil and petrol resistant)

LENGTH

Profile: 2.5 meters
Plates: 2.5 meters
Insert: 25 meters
Shirt: 50 meters

STANDARD COLOR OF INSERT (RAL)

9005

Profile	A (mm)	H (mm)	Bw (mm)	Bp (mm)	Bi ¹ (mm)	C (mm)	Hp (mm)	Mx (mm)	My (mm)	Load bearing capacity, kN			
WR 79/120/80	120	80	148	280	O/R ¹	65	4	120 (+60/-60)	20 (+10/-10)	50	300	70	—
WR 79/120/90	120	90	148	280	O/R ¹	65	6	120 (+60/-60)	20 (+10/-10)	50	300	70	—
WR 79/120/100	120	100	148	280	O/R ¹	65	6	120 (+60/-60)	20 (+10/-10)	50	300	70	—
WR 79/120/120	120	120	148	280	O/R ¹	65	6	120 (+60/-60)	20 (+10/-10)	50	300	70	—
WR 79/120/140	120	140	148	280	O/R ¹	65	6	120 (+60/-60)	20 (+10/-10)	50	300	70	—
WR-H 79/120/A ²	120	O/R ²	118	O/R ³	O/R ¹	70	5	120 (+60/-60)	20 (+10/-10)	50	300	70	—

¹ Bi - shirt width. Depends on the type of shirt and the mounting height of the profile. Ask for additional information.

² The profile can be made to any height from 75 to 1000 mm. In this case, it is completed with steel guide angles to the required mounting height. **A** - the value of the selected profile height.

³ Depends on the installation height of the profile.

NOTE!

! The specified IP rating is applicable if the waterproofing of the floor is matched with profile aprons.

! If there is a vertical movement using the lining "F" are not allowed.

! By agreement, it is possible to use asphalt in the finish coating.



Profile versions

Profiles can be equipped with protective plates to protect the insert from mechanical damage. This type of profile has an index "F".

Example WR 79/120/100/S F

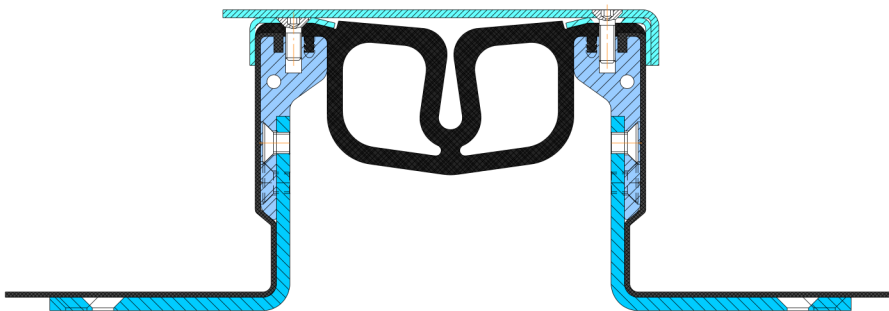

At low loads, side mounting is possible.

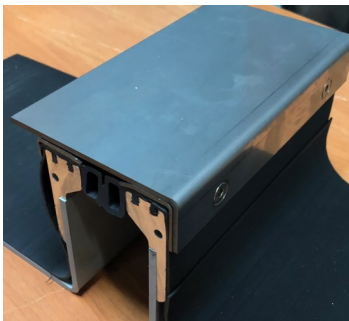

Corner Versions

All profiles have angular versions in which the regular insert is replaced with an angular one. This profile has an E index.

Example: WR-E 79/120/100/S

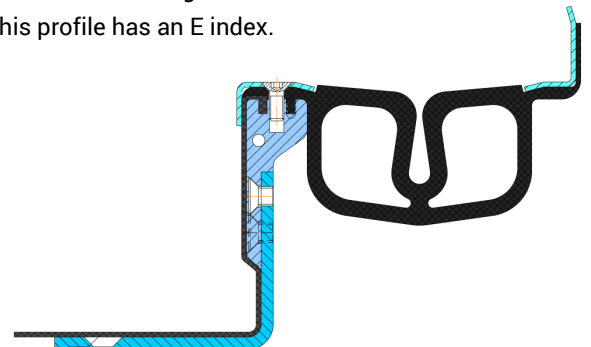

On request

On request, the profile can be completed with special linings that form the transition zone between the profile and the finishing coating.

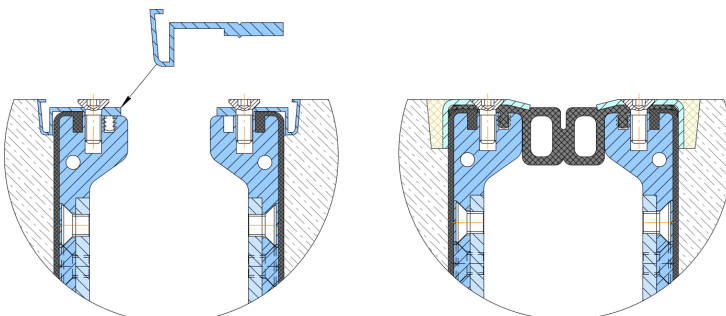

Types of shirt

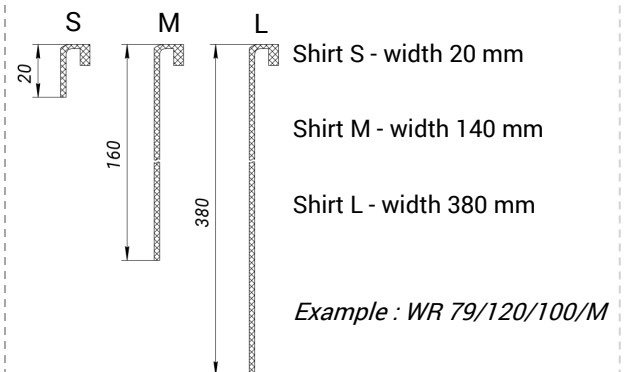

Example : WR 79/120/100/M