



**DEWMARK
HEAVY**

SV 46/320



Joint width
320 mm



Top
mounted



Max load
100 kN



Movements in
3 directions



Protection
rating IP 30



Indoor/
outdoor

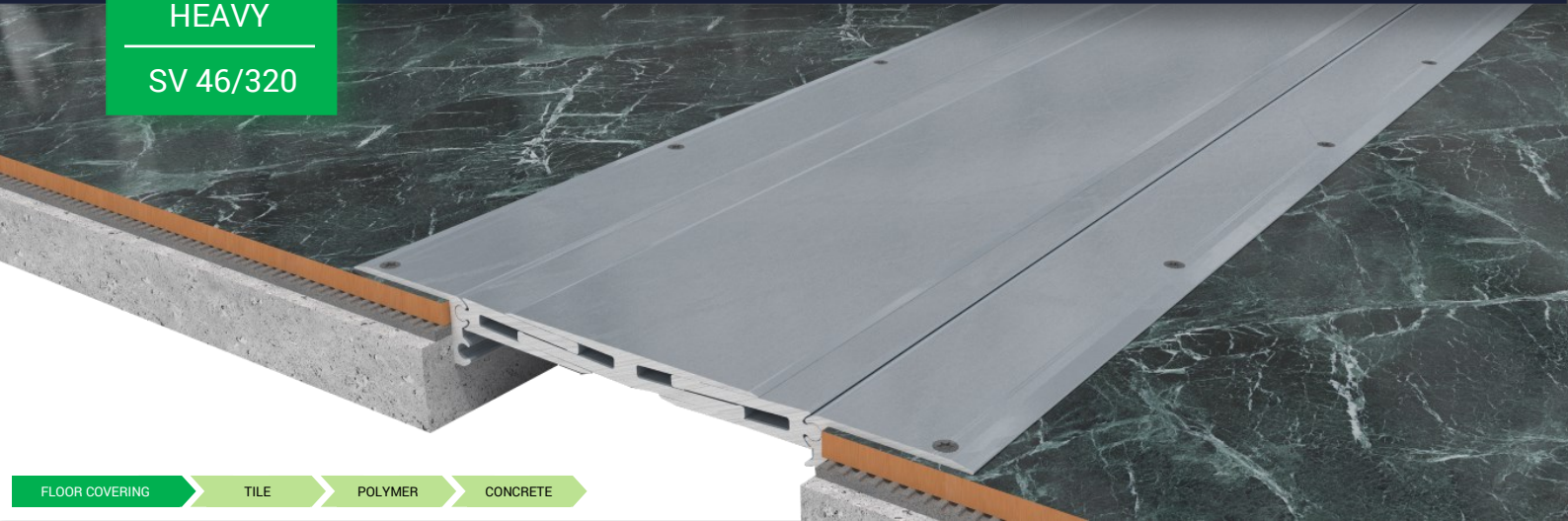

FLOOR COVERING → TILE → POLYMER → CONCRETE

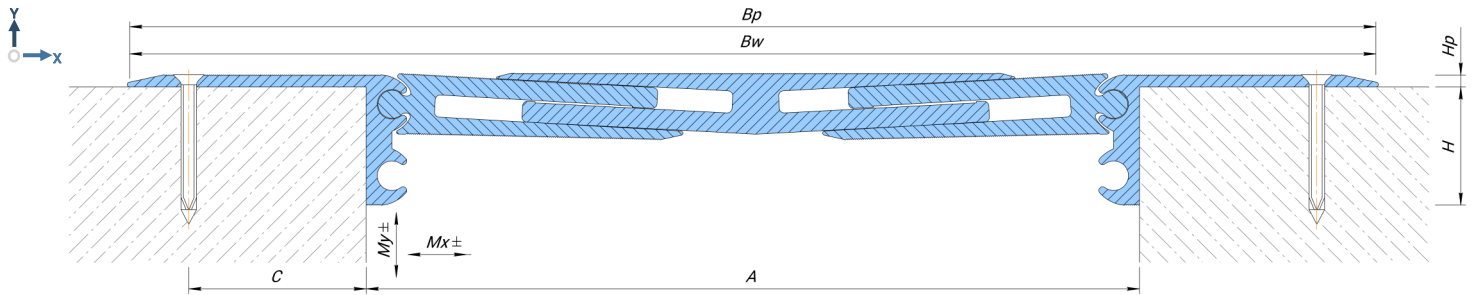

Profile	A (mm)	Bw (mm)	Bp (mm)	H (mm)	Hp (mm)	C (mm)	Mx (mm)	My (mm)	Load bearing capacity, kN			
SV 46/320/N	320	514	514	48	5	72	70 (+35/-35)	70 (+35/-35)	50	100	70	10 ¹

¹ Not for permanent use (requires coordination)

Technical data

MATERIAL

Aluminium EN AW 6060T6

LENGTH

3 meters

STANDARD COLOR

silvery white

On request

Protective anodizing profile

Corner versions

All profiles have a corner version (wall to floor under an angle of 90 degrees). One of the guides is replaced by a corner guide.

This profile is denoted by the index "E":

example SV-E 46/320/N

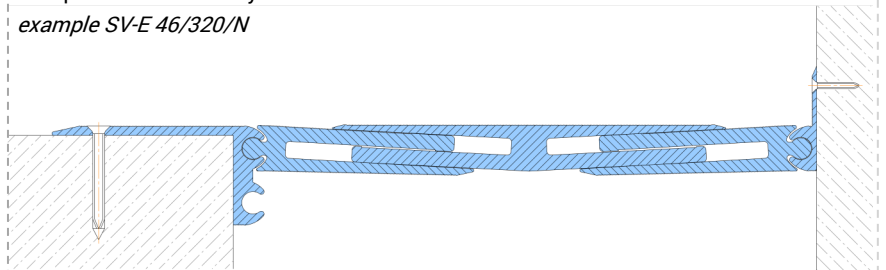

! For corner versions, only pedestrian loads are allowed.